

ng line to ROSEWOOD

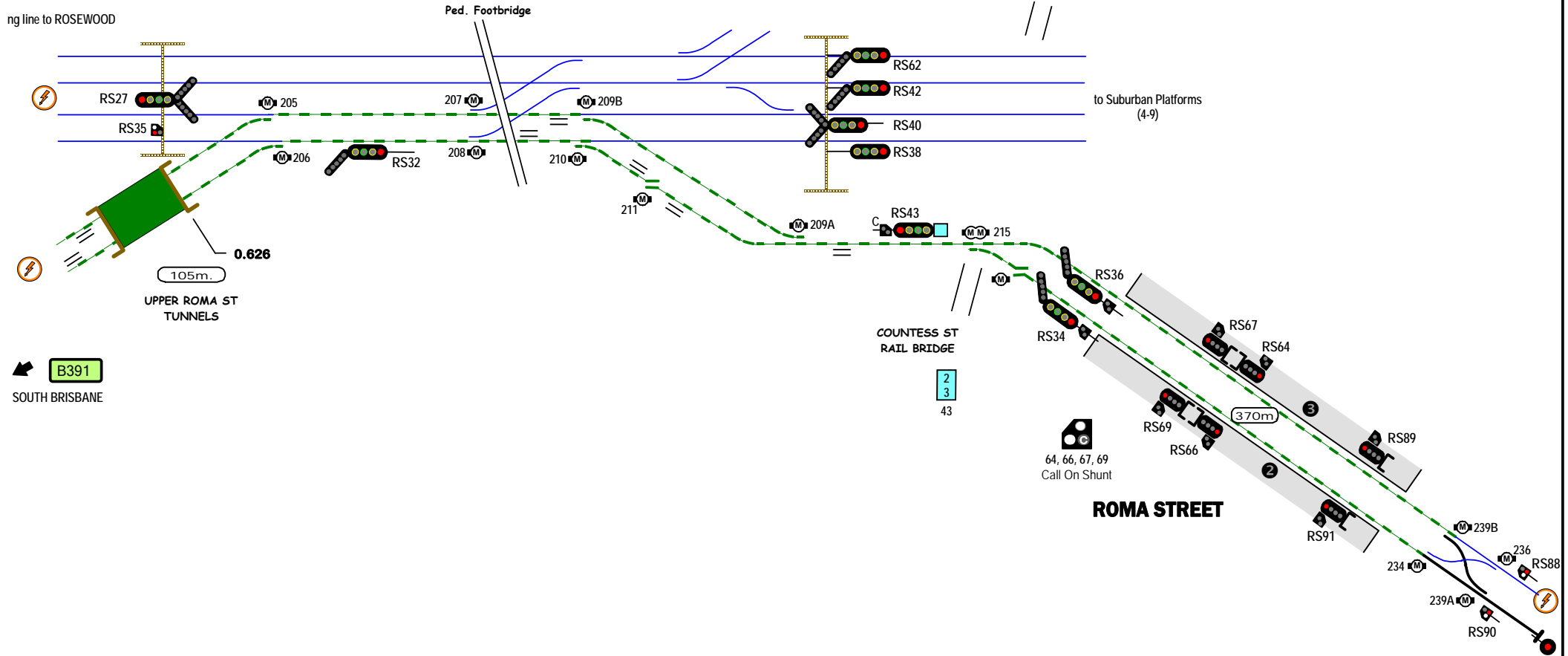

STANDARD GAUGE TRACK —————

DUAL (sg + ng) TRACK - - - - -

NARROW GAUGE TRACK —————

This drawing shows the STANDARD GAUGE access to ROMA STREET station. Adjacent NARROW GAUGE track and signalling is only included to the extent of identifying signals that permit access to, or protect the standard (mixed) gauge main.

ROMA STREET

Signal Locations

Home Support

© 2011 G F Vincent

B392