

ng line to ROSEWOOD

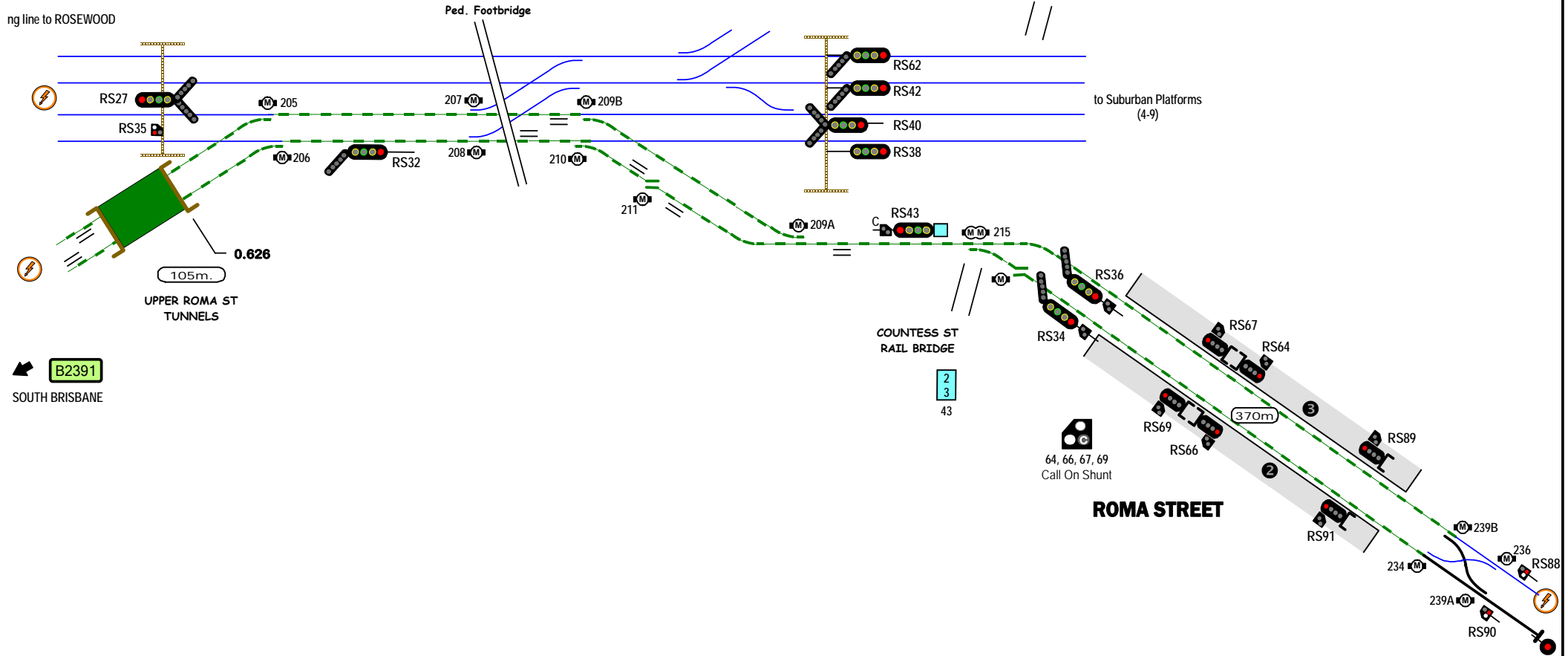

B2391
SOUTH BRISBANE

ROMA STREET

This drawing shows the STANDARD GAUGE access to ROMA STREET station. Adjacent NARROW GAUGE track and signalling is only included to the extent of identifying signals that permit access to, or protect the standard (mixed) gauge main.

Signal Locations

Home Support

© 2011 G F Vincent

STANDARD GAUGE TRACK —————

DUAL (sg + ng) TRACK - - - - -

NARROW GAUGE TRACK —————

ROMA STREET

B2392